

# ***Rocky Mountain Round Up*** **RANCH TRIAL**

*All breeds recognized by ASCA as herding breeds are eligible to enter the trial.*

***August 2, 2018***



## **Robert McClain's Ranch**

18667 Hwy 86  
Calhan, CO 80808

***Entries Open July 2, 2018 and close July 28, 2018***

**1 Trial / 8 Runs CATTLE only - Judge: Fiona Hibbard**

	<b><i>Pre-Entry</i></b>	<b><i>Day of Trial</i></b>
<b><i>Entry Fee</i></b>	<b><i>\$50.00</i></b>	<b><i>\$55.00</i></b>

## **SCHEDULE**

**8:00 am Handler's meeting**  
**8:30am Trial begins**

*Course Director/Entry Clerk: Terri Morgan*

*Checks payable to: CASA (Colorado ASA)*

*Mail to: Terri Morgan*

*PO Box 104, Kiowa, CO 80117*

*720-272-8998 [carolais1@aol.com](mailto:carolais1@aol.com)*

## GENERAL INFORMATION

These is an ASCA sanctioned trial and all ASCA rules apply ([www.asca.org](http://www.asca.org)). Dogs over 6 months of age must have proof of ASCA registration available. CASA, the Course Director and club members assume no responsibility for any loss, damage or injury sustained by any exhibitor, handler, dog, property, children or spectator. All dogs must be crated or leashed except while competing.

Entry fees will not be returned if the trial cannot be opened or be completed due to riots, civil disturbances, acts of God, public emergencies or other events beyond the control of CASA. Entry fees will not be refunded if the dog is absent, disqualified, excused or barred from competition by the Show Committee, ASCA, show veterinarian or the judge.

All entries must be on the official ASCA entry form with proper fees included. Exhibitors are responsible for the accuracy of the entry and the class entered. Withdrawal of entries will be accepted until the pre-entry closing date. Returned checks do not constitute a valid entry and there will be a \$35.00 service fee on all returned checks. Entry into future shows/trials and participation in this show/trial will not be allowed until all fees are paid in cash or money order.

**Information:** Substitutions are allowed providing the dog is owned by same owner. Draw for run order will be after trial registration closes. Bitches in heat will run in order of draw, but must be crated and exercised away from the competition. All breeds recognized by ASCA as herding breeds are eligible to enter the trial.

Stock to be used: 10 head of 300 to 800# black angus or mixed calves. Owners of dogs will be responsible for all injuries to livestock; replacement cost per cow is current market value.

You are responsible to be on site for your runs.

**Awards:** Flat ribbons offered for class placements

Ribbons and Awards for High In Trial

Veterinarian on call: Comanche Creek Veterinarian - 524 Comanche St, Kiowa, CO 80117 303-621-2054

**LODGING:** Please verify respective hotel pet policy when making reservations:

Comfort Inn North - 6450 Corporate Dr., C/S -719-262-9000

Days Inn Academy – 8350 Razorback Rd., C/S – 719-266-1317

Super 8 – 8135 N. Academy, C/S – 719-528-7100

Red Roof Inn – 8280 State Hwy 83, C/S – 719-598-6700

LaQuinta Inn – 4385 Sinton Rd, C/S – 719-528-5060

BRING SHADE, chairs, rain gear and water! There will not be any concessions on site for this trial.

### DIRECTIONS

USE GOOGLE MAPS for best directions from your location!

Location is approximately 10 miles  
east of Kiowa on the south side of Hwy 86.

CASA President: Geri Scheidt VP: Libby Stibley  
Secretary: Terri Morgan Treasurer: Wendy Summers  
BOD: Rebecca Jennings, Claudia Yearsley, Becky Parker  
<http://www.coloaussies.org/events.html>

Points	Description
Pen: 5	Handler to take 10 head out of Pen 2, through Gate 1, into Pen 3. Task ends when handler shuts Gate 1.
Pen: 5	Handler takes cattle out of Pen 3, through Gate 2 to Pasture. Task ends when Gate 2 is shut.
Pasture: 40	Handler to stay w/in a stick length of Gate 1 and move 10 head clockwise around Cone 1, counter clockwise around cone 2, counter clockwise around cone 3 and through Gate 3 into Pen 4. Task ends when Gate 3 is shut.
Chute: 20	Cattle are to be moved counter clockwise in Pen 4 through the Chute and through Gate 4. Task ends when Gate 4 is shut.
Sort: 20	5 pre-designated head will be sorted into the Alley though Gate 5. Task ends when 5 head are in the Alley.
Pen: 10	The 5 head in the Alley will be put into Pen 5. The 5 head left in Pen 3 will be put into Pen 6. Both groups of cattle from Pens 5 and 6 will be taken out and put into Pen 1. Task ends when Gate 8 is shut.

8/2/18 Colorado ASA  
Ranch trial  
description

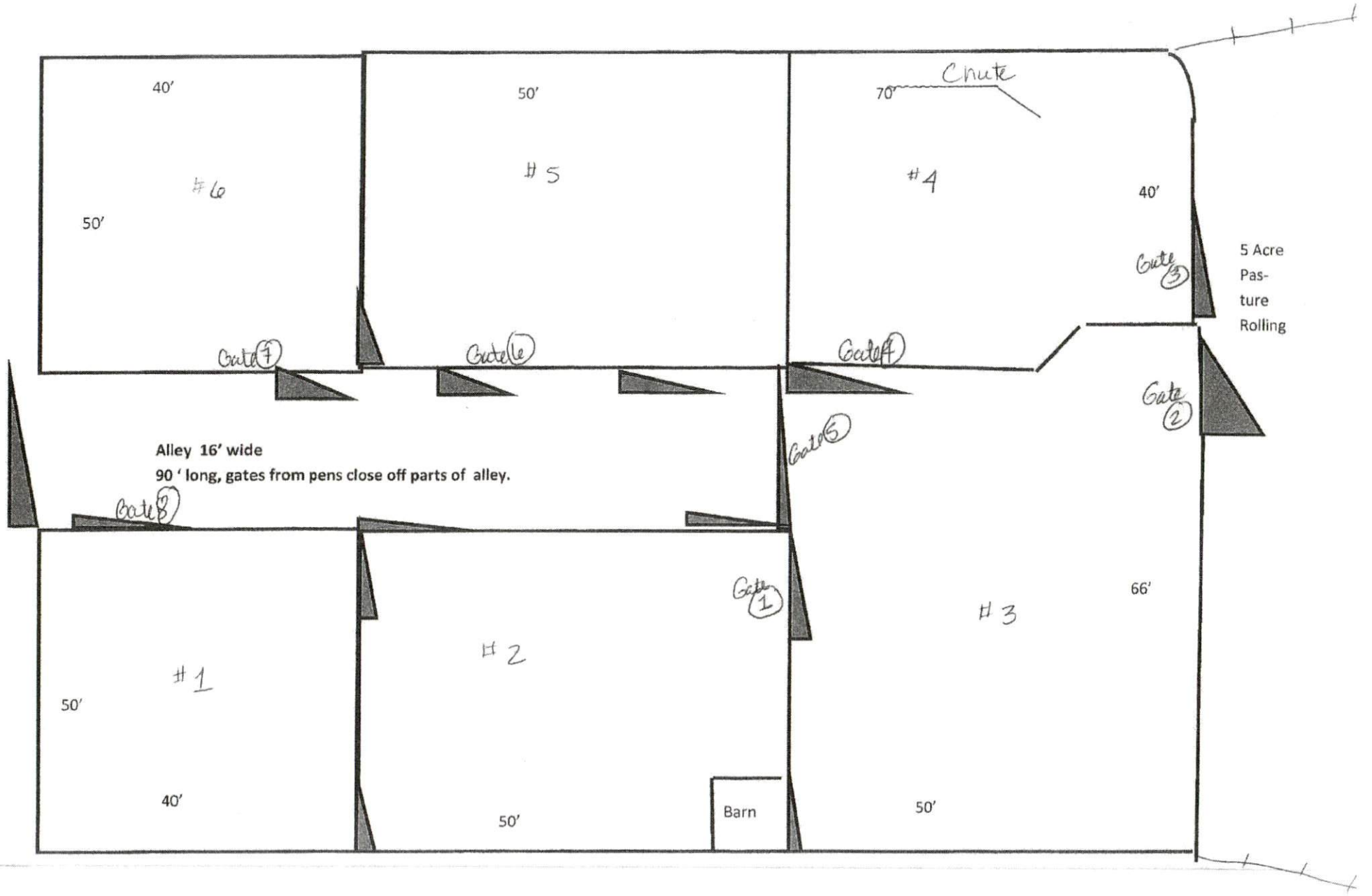

Gates

8/2/10 Colorado ASA Ranch Trial per layout



Pen #4

Gate ③

Gate ②

Handlee

Pen #3

5 acre  
Rolling  
pasture

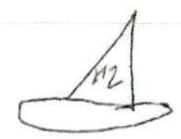
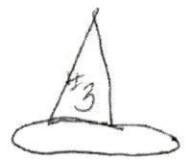

Colorado ASA  
81218 Ranch  
Thal course-  
pasture