

Outback ASC Presents

June Jamboree Farm Trial

June 8, 2018

ASCA Farm Trial * ASCA sanctioning pending* Ribbons Only

SHOW SECRETARY: Kay Fuecker COURSE DIRECTOR: Marie Murphy

Handlers Meeting 7:45am – 8:00 am Trial starts: 8:30am

8 runs-mixed stock

JUDGE: Ken Silveira

LOCATION:

Pat & Marie Murphy Farm
N3029 945th St
Hager City, WI 54014

ENTRY INFORMATION

8 runs- mixed stock trial- sheep and ducks

The stock will be sheep and ducks with 10 head of ducks and 9 head of sheep per run.

The course time will be 30 minutes.

There will be time warnings at 10, and 3 minutes

The tie breaking task is the duck sort.

\$50 per run

Day of entries taken 7:00 - 7:30am

Bitches in season are not allowed, but substitutions and refunds will be allowed.

Run order will be drawn the day before the trial.

COURSE POINTS

Pen work - 45 points

Sort - 15 points

Chute work - 15 points

Gather - 20 points

Pasture Work - 20 points

Bridge - 15 points

PRE-ENTRIES OPEN MAY 1st AND MUST BE POSTMARKED BY JUNE 5, 2018. Send entries to Kay Fuecker,
W9585 – 295th Ave, Hager City WI, 54014.

ENTRY FORMS AVAILABLE ON THE ASCA WEBSITE. www.asca.org/formsandrulebooks -

THIS IS AN ASCA SACTIONED EVENT. ALL ASCA RULES WILL BE FOLLOWED.

DUCK FARM TRIAL COURSE

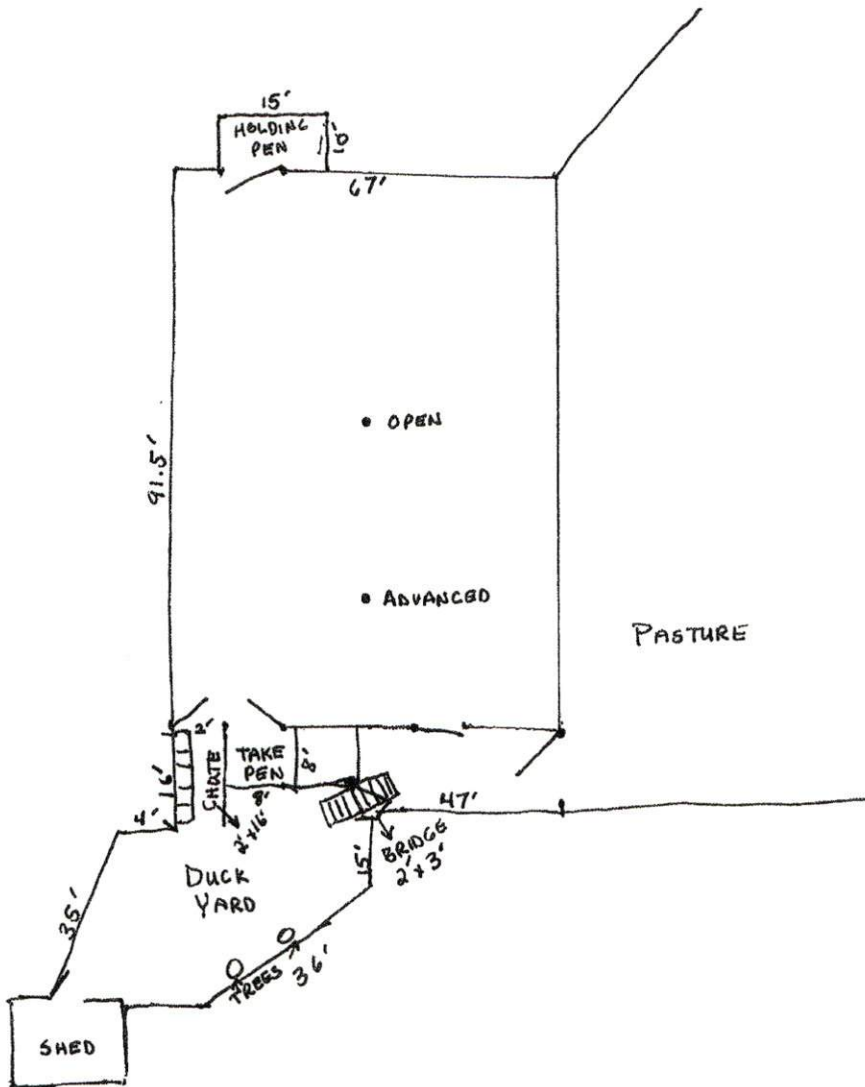

SHEEP FARM TRIAL COURSE

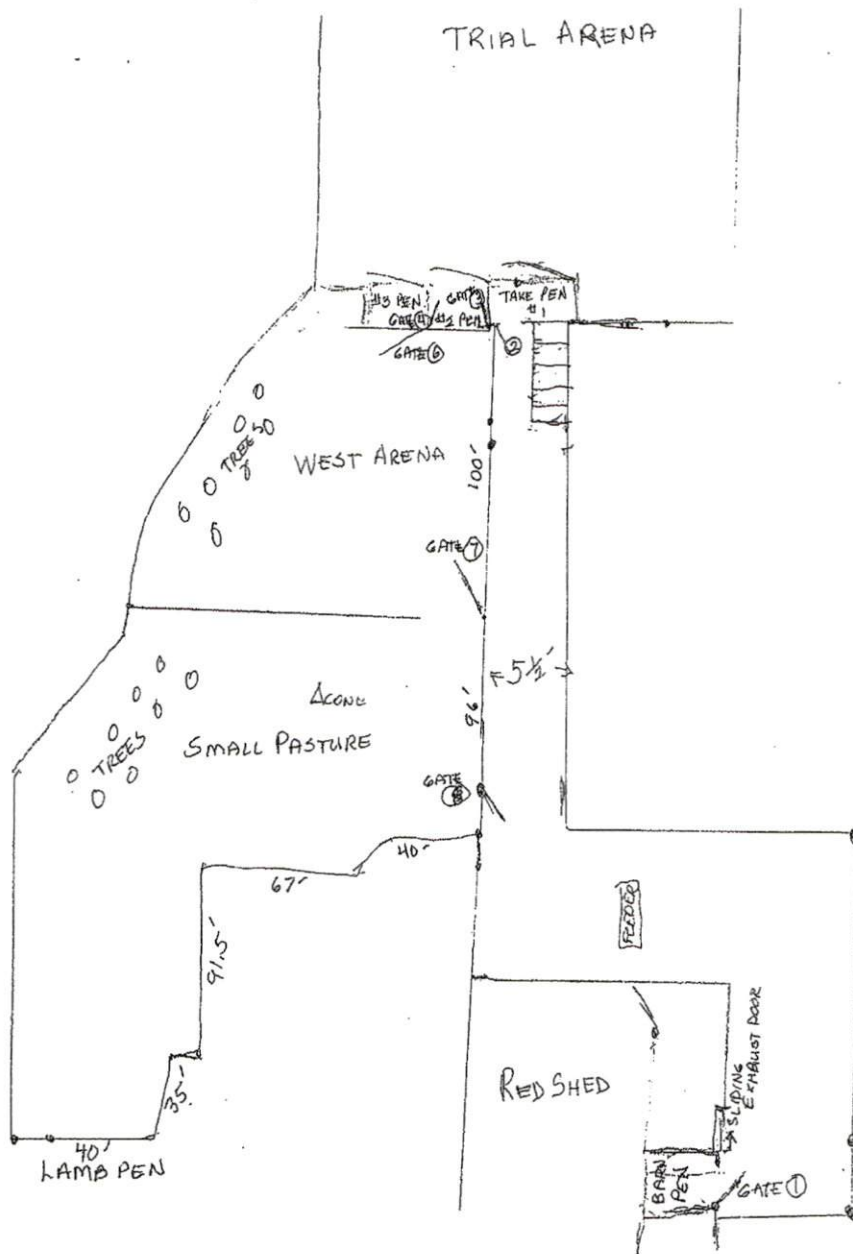

- Pen #1-the barn pen-16x16, 6 ft gate
- Pen #2-Take pen #1-16x16, 16 ft gate
- Pen #3-Take pen #2-16x16, 16 ft gate
- Pen #4-Take pen #3-16x16, 16 ft gate

Outback Mixed Farm Trial Course

1. Start at DUCKS

GATHER (20 points)

2. Gather ducks in arena
 - a. **Open:** Handler leaves dog at Advanced Handlers cone. Handler may stand at the 'open cone' (1/2 the distance) and send dog and fetches ducks to the take pen
 - b. **Advanced:** Handler stands at 'advanced cone' sends dog and fetches ducks to the take pen.

SORT (20 points)

3. Sort three marked ducks into take pen.

CHUTE (10 points)

4. Open gate to chute and take the remaining ducks through the 'chute' (aisle way) to the duck yard. Sprinkle dust on the ducks
 - a. **Open-**doorway to shed in duck yard will be closed (so ducks cannot escape into shed)
 - b. **Advanced:** doorway to shed will be left open

BRIDGE (Location Specific Task 1- 20 points)

5. Dogs will take the ducks through the duck yard, over bridge to pasture and handler shuts the pasture gate.
 - a. **Open:** Handler can move with dog to pasture and shut gate when the ducks are through.
 - b. **Advanced:** Handler stays at bridge until ducks are in pasture, then goes to shut the gate.

Move to Sheep

PEN WORK (40 Points) Course starts at barn:

1. Pen 1: Open Gate #1
 - a. Open: Handler may go into the barn with the dog to bring the sheep out
 - b. Advanced: Handler sends dog in to fetch sheep.
2. Handler shuts Gate #1. Sheep are taken to and down the aisle way through Gate #2 into Pen #2.
3. Pen 2: Six sheep are sorted from take pen #2 into take pen #3
4. Pen 3: Three Sheep are sorted from take pen #3 into take pen #4
5. Open: Handler and dog move sheep from pens #2, and #3 into pen #4

6. Advanced: Dog moves sheep from take pen #1 into the arena. Handler moves to take pen #2 and the dog moves those sheep into the arena. The six sheep out in the arena are moved into pen #4. Nine sheep are in pen #4
7. Pen. 4: Handler opens Gate #6 , dog takes the nine sheep out into the west arena.

PASTURE WORK (Location Specific Tasks #2, 20 points)

8. Handler opens Gate #7, lets the sheep out into the small pasture. Sheep will run to the far end of the small pasture towards the lambs' pen. Let the sheep settle.
 - a. Open: Handler goes with the dog to fetch sheep, then moves sheep through Gate #8 to the barn. Opens the sliding door and exhaust sheep into the barn.
 - b. Advanced: Handler moves to the cone and sends dog to fetch sheep, when the sheep are moving towards handler, handler can open Gate #8 and move sheep to the barn, open sliding door and exhaust sheep into barn.

Sheep:

Pen Work

Location Specific Task 2 Pasture Work

Ducks:

Gather

Sort

Chute

Location Specific Task 1 Bridge

Time Allowed: 20 minutes

Tie Breaker: Duck Sort