

ASCME

Australian Shepherd Club of Maine

Downeast Stockdog TrialsJuly 13th – 14th, 2019**** 4 Trials In One Weekend ****

Sanction pending / ASCA rules

Flying M Searsport, ME (cattle) Lone Moose Farm Prospect, ME (sheep & ducks)

Trial sites are 5 miles from each other

Trials will be held under the current ASCA rules and regulations and will be open to all ASCA recognized herding breeds. Non-ASCA registered dogs must acquire a tracking number prior to the trial to have scores count toward ASCA titles. For rules, entry forms and tracking forms visit www.asca.org. No entry shall be accepted from a dog &/or handler disqualified from ASCA programs or a person not in good standing with ASCA.

OPENING POSTMARK: June 1st, 2019 PRE-ENTRIES CLOSE: July 5th, 2019**ASCA Judges:** Robert Myrick (GA) and Jan Wesen (WA)**Course Director:** Cindy Reynolds Tel: (207) 548-0995 email: vetcindy@roadrunner.com**Entries / Trial Secretary:** Warren Evans Tel: (207) 894-5030 email: warren.evans@martinspoint.org**Send entries to:** Warren Evans 12 Evans Ridge Rd Windham, ME 04062**Make checks payable to ASCME****TOTAL RUNS PER DAY, PER STOCK & ENTRY FEES:**

Stock	Type	Pre-Entry Fee	July 13, 2019	July 14, 2019
Cattle	3 – Beef/Dairy Cross	\$55.00*	12 & 12	12 & 12
Sheep	3 - Katahdins	\$45.00*	16 & 16	16 & 16
Ducks	5 – Calls	\$30.00*	12 & 12	12 & 12

\$460.00 same dog, all stock, both days. Pre-entry only. Save \$60**\$235 per day, same dog, all stock, July 14th or July 15th. Pre-entry only. Save \$25**

Day of Trial entry, if available: Add an additional \$5 per class

Day of trial entries will be taken if trial is not full. Entry fees are non-refundable unless there is an entry on the waiting list to replace it.

Cattle arena is outdoors on gravel. Sheep and duck arenas are outdoors on grass. In the event of a dog injuring stock, the owner/handler will be responsible for all vet fees, replacement fees (cattle – market value / sheep \$250 / ducks \$35) and disposal fees.

Dogs must be confined or on leash at all times when not working. Individuals are responsible for any damage done to stock and/or facilities. Dogs that attack or maul any person, dog or livestock will be disqualified. Please pick up after your dog in all areas.

ASCME, its members and Trial Committee, host facility owners Cindy Reynolds and Greg & Laura Hamer and their associates, assume no responsibility for any loss, damage or injury sustained by any exhibitor, handler, dog, property, child or spectator. These trials are being held on private property. You understand by your attendance and/or entry that the Show/Trial Committee have the right to refuse or excuse any entry or spectator for good cause. Good cause would be violation of the private property owners' rights or violation of the ASCA show rules.

AWARDS:

Ribbons will be awarded for 1st thru 4th place. Qualifying prizes will be given.

There will be a High Combined award given to the Aussie, Other Breed and Started Dog with the highest cumulative score earned in the eight arena classes offered over the two days of trials.

Please let us know if you could get your WTCH at these trials.

TRIAL SCHEDULE

DATE	LOCATION	STOCK	JUDGE	COURSE	CHECK-IN	HANDLER'S MEETING	TRIAL START
7/13/2019	Flying M	Cattle 1	Robert M	A	7:45 A.M.	8:00 A.M.	8:15 AM
7/13/2019	Flying M	Cattle 2	Jan Wesen	H	9:15 A.M.*	9:30 A.M.*	9:45 A.M.*
7/13/2019	LMF	Sheep 1	Robert M	B	12:00 P.M.**	12:15 P.M.	12:30 P.M.
7/13/2019	LMF	Sheep 2	Jan Wesen	H	2:15 P.M.*	2:30 P.M.*	2:45 P.M.*
7/13/2019	LMF	Ducks 1	Jan Wesen	A	12:00 PM**	12:15 PM	12:30 PM
7/13/2019	LMF	Ducks 2	Robert M	C	2:15 P.M.*	2:30 P.M.*	2:45 P.M.*
7/14/2019	Flying M	Cattle 1	Jan Wesen	H	7:45 A.M.	8:00 A.M.	8:15 AM
7/14/2019	Flying M	Cattle 2	Robert M	B	9:15 A.M.*	9:30 A.M.*	9:45 A.M.*
7/14/2019	LMF	Sheep 1	Jan Wesen	H	12:00 PM**	12:15 PM**	12:30 PM**
7/14/2019	LMF	Sheep 2	Robert M	A	2:15 P.M.*	2:30 P.M.*	2:45 P.M.*
7/14/2019	LMF	Ducks 1	Robert M	A	12:00 PM**	12:15 PM**	12:30 PM**
7/14/2019	LMF	Ducks 2	Jan Wesen	H	2:15 P.M.*	2:30 P.M.*	2:45 P.M.*

* Or 15 minutes (check-in), 30 minutes (handler's meeting), 45 minutes (trial start) after the conclusion of #1 Stock trials.

** Or one half hour (check-in), 45 minutes (handler's meeting), one hour (trial start) after the conclusion of the cattle runs and awards. Sheep and duck trials will run concurrently. #2 Duck Trials may have to wait for judge from Sheep Trial #1.

**RUN ORDER WILL BE BY COMPUTERIZED RANDOM DRAW THE EVENING PRIOR TO THE TRIAL
BITCHES IN SEASON WILL RUN LAST**

Directions to trial sites:

FLYING M 434 EAST MAIN STREET SEARSPORT, ME 04974

From the South:

I-95 to Exit 113. Follow ME Route 3 north for 44 miles to US Route 1 north. Turn left onto US Route 1 north. Follow for 9.6 miles. Flying M will be on your left.

From the East:

From the bridge in downtown Ellsworth (on US Route 1) follow US Route 1 south / ME RT 3 south for 27.8 miles. Flying M will be on your right. It is roughly 0.5 miles past Just Barb's Restaurant.

From the North:

I-95 to Exit 180. Take a left off of the exit ramp onto the Coldbrook Rd. Follow for 1.6 miles. Just before the light, bear right onto the US Route 202 west. Follow for 0.8 miles. At the light take a left onto ME Route 9. Follow for 0.4 miles. At light take a right onto US Route 1A south. Follow for 19.3 miles. Bear right onto US Route 1 south. Follow US Route 1 south for 1.0 mile. Flying M will be on your right. It is roughly 0.5 miles past Just Barb's Restaurant.

LONE MOOSE FARM 63 HAWES BRIDGE RD PROSPECT, ME 04981

From the South:

Take I-95 to Exit 113. Follow ME Route 3 north for 44 miles to US Route 1 north. Turn left onto US Route 1 north. Follow for 10.6 miles. Take a left onto US Route 1A north. Go 4.4 miles. Turn left onto the Hawes Bridge Rd. Lone Moose Farm is 0.2 miles on the right.

From the East:

From the bridge in downtown Ellsworth (on US Route 1) follow US Route 1 south / ME Route 3 south for 20.6 miles. Turn right onto ME Route 174 at the light at the end of Penobscot Narrows Bridge. Go 3.8 miles. At stop sign, cross US Route 1A onto the Hawes Bridge Rd.. Lone Moose Farm is 0.2 miles on the right.

From the North:

I-95 to Exit 180. Take a left off of the exit ramp onto the Coldbrook Road. Follow for 1.6 miles. Just before the light, bear right onto US Route 1A south. Follow for 14.9 miles. At junction of US Route 174 and the Hawes Bridge Road, directly after The Pit Stop and the Prospect Fire Dept., take a right onto the Hawes Bridge Rd. Lone Moose Farm is .02 miles on the right.

MOTELS AND CAMPGROUNDS

BELFAST HARBOR INN (recommended)

(LARGE FIELD; ON THE OCEAN)

1-800-545-8776

91 SEARSPORT AVE. (ROUTE 1)

BELFAST, ME 04915

13 MILES AWAY

FIRESIDE INN

(ON THE OCEAN; RESTAURANT & MOTEL)

207-338-2090

159 SEARSPORT AVE. (ROUTE 1)

BELFAST, ME 04915

13 MILES AWAY

BUCKSPORT MOTOR INN (recommended)

(SMALL, CLEAN; WALKWAY ON RIVER)

1-800-626-9734

70 US ROUTE 1

BUCKSPORT, ME 04416

6 MILES AWAY

ECONOLIDGE

(CLOSE TO AIRPORT, SHOPPING, CASINO)

207-945-0111

327 ODLIN RD

BANGOR, ME 04401

21 MILES AWAY

HOLIDAY INN

(CLOSE TO AIRPORT, SHOPPING, CASINO)

207-947-0101

404 ODLIN RD

BANGOR, ME 04401

21 MILES AWAY

SEARSPORT SHORES CAMPGROUND

(ON THE OCEAN)

207-548-6059

216 WEST MAIN STREET

SEARSPORT, ME 04974

11 MILES AWAY

RV CAMPING ON SITE: LIMITED SPACE FOR

SELF-CONTAINED RV'S WILL BE

AVAILABLE FOR \$10.00 A

NIGHT. CONTACT LAURA HAMER FOR

MORE DETAILS AT 207-567-3567

OR VIA EMAIL AT lmfarm@fairpoint.net

VETERINARIANS

Eastern Maine Emergency Veterinary Clinic

Dirigo Drive Brewer, ME 04412

(207) 989-6267

Weekday veterinarians:

Ridgerunner Vet Clinic

559 South Main Street Winterport, ME 04496

(207) 223-2596

Searsport Veterinary Hospital

322 West Main St Searsport, ME 04974

(207) 548-2924

(Weekends: every other Saturday)

Bucksport Veterinary Hospital

1.1 Gross Point Rd Orland, ME 04472

(207) 469-3614

(open Saturdays until noon)

CATTLE ARENA @ FLYING M

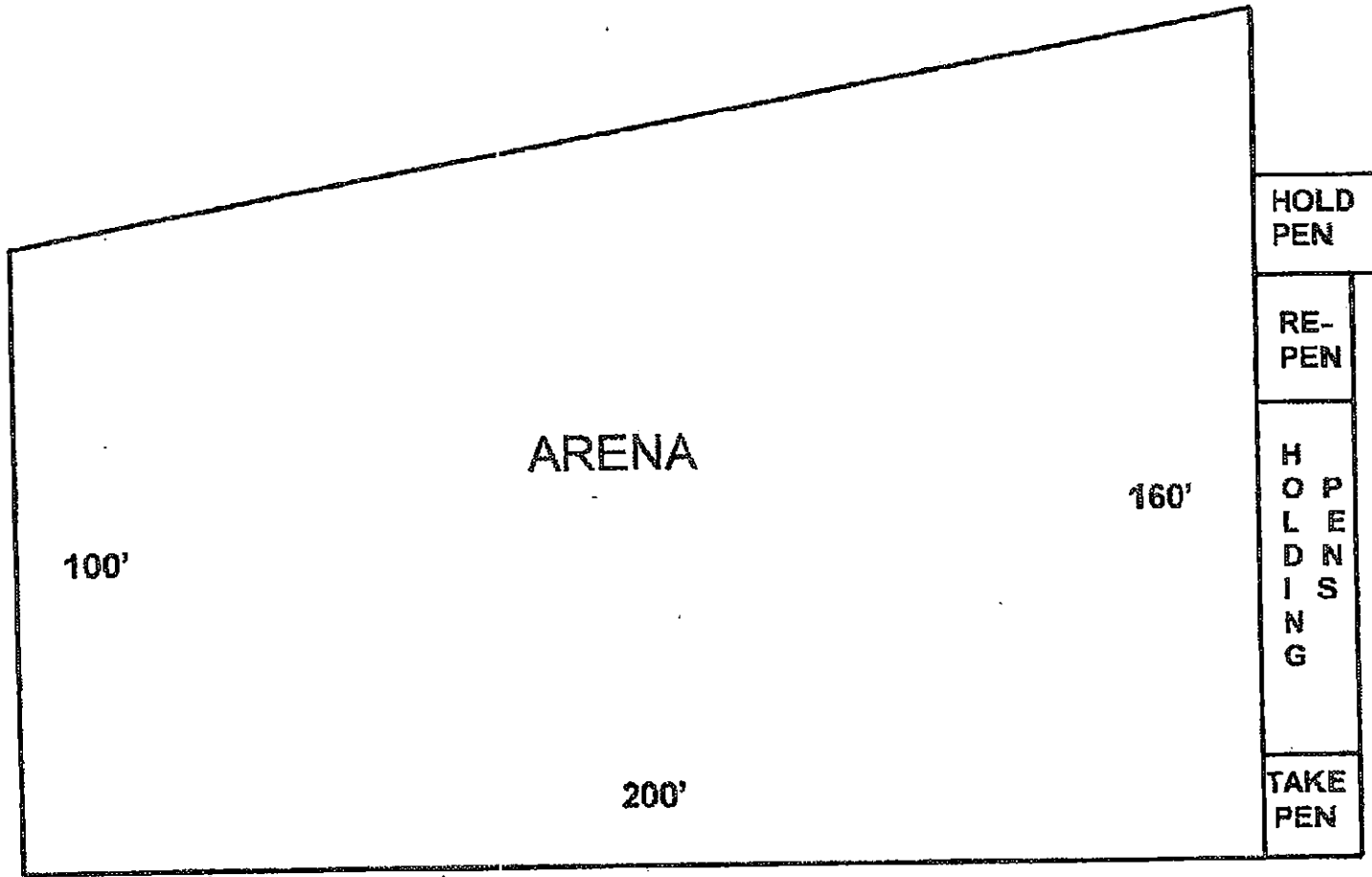

Take Pen - 16' X 16'
Re-Pen - 16' X 20'

DUCK ARENA @ LMF

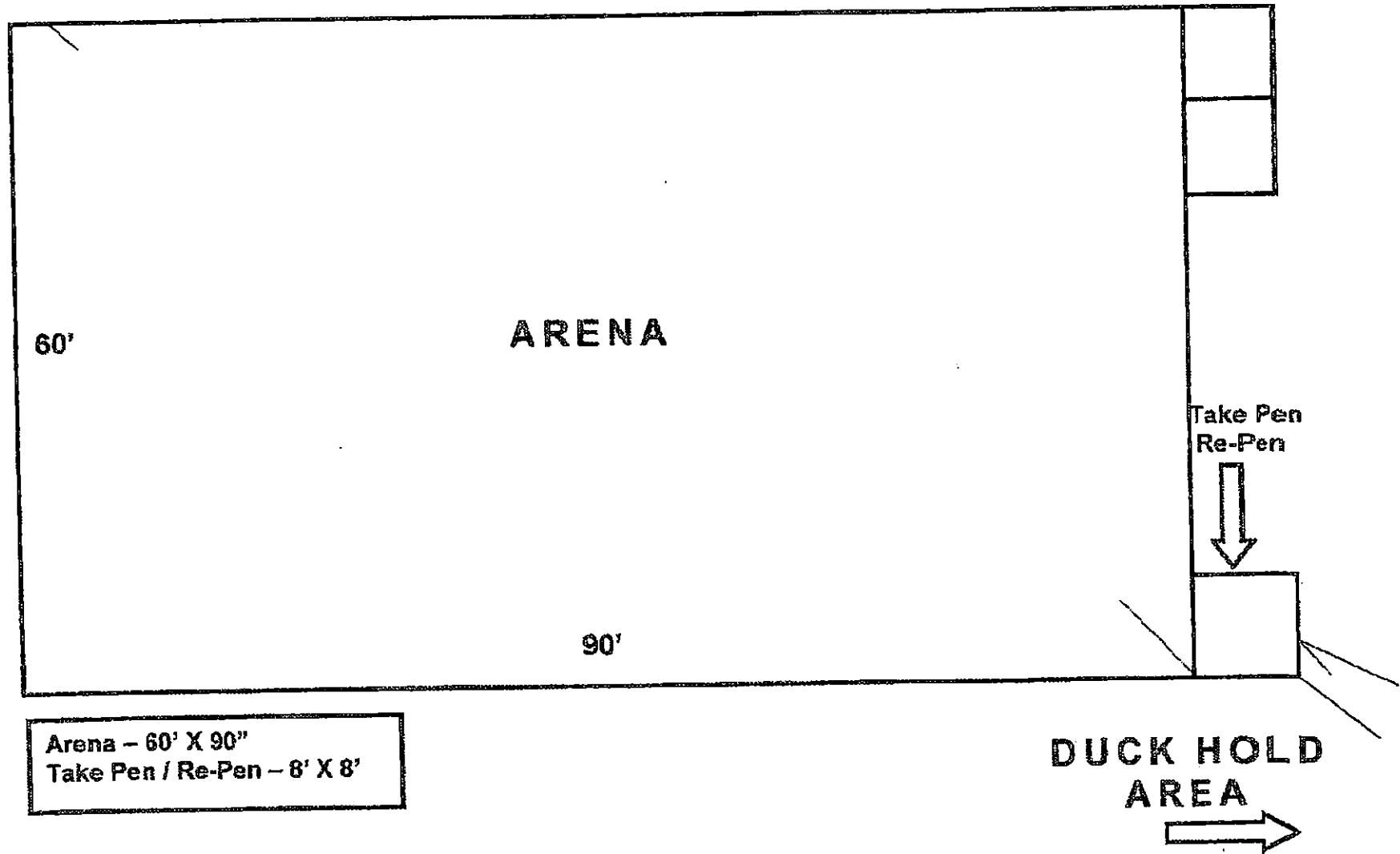

SHEEP ARENA @ LMF

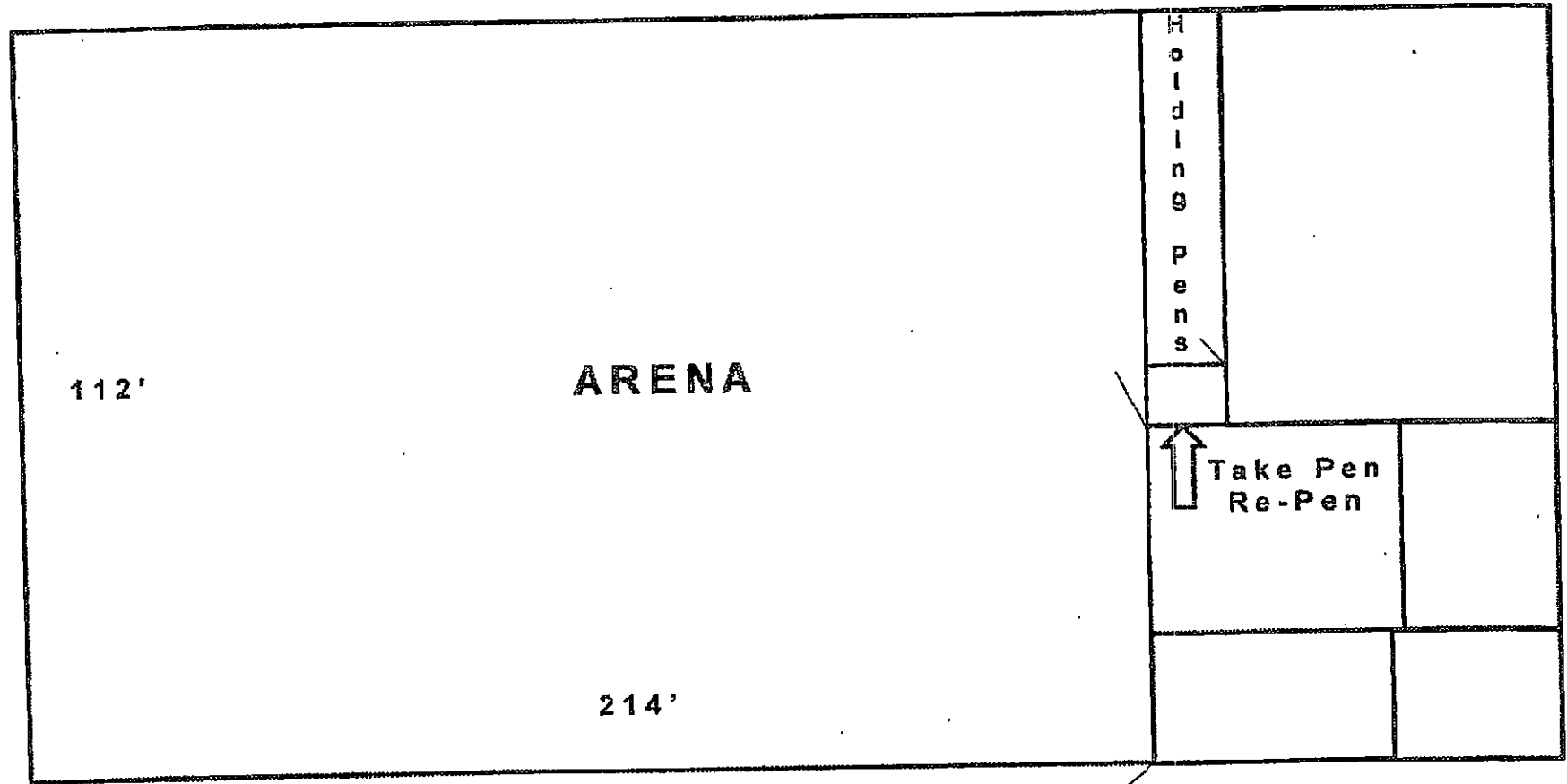

Take Pen / Re-Pen- 10' X 14'
Arena - 112' x 214'